

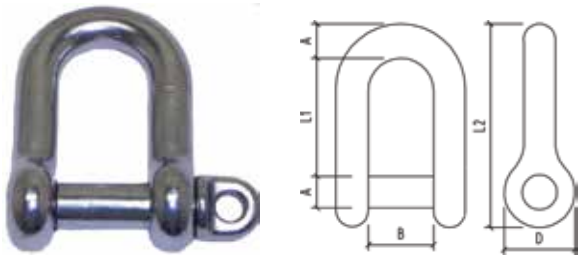

ABOVE ITEM IS AVAILABLE IN THE BRIDCO LOAD RATED RANGE OF COMPONENTS.
SEE PAGE 48 FOR FURTHER DETAILS.
F = FORGED

STANDARD DEE SHACKLE

Code	A	B	D	L1	L2	TDL (KG)
SS-360F-05	4.8	10.8	9.8	18	30	400
SS-360F-06	5.8	13.5	12	21	36	550
SS-360-07	6.8	14.5	13.5	24.2	41.3	720
SS-360F-08	7.6	17.3	15.9	29.7	48.2	1120
SS-360F-10	9.7	22.5	20	35.7	60	1600
SS-360F-12	11.6	27	23.7	43.1	70	2400
SS-360-16	16	32	31.8	56	95	3600
SS-360-19	19	38	37.6	66	110	4400
SS-360-25	24.7	50.4	49.7	87	148.7	TBA
SS-360-32	31.2	64.4	64.6	110.1	190	TBA



CAPTIVE PIN DEE SHACKLE

Code	A	B	D	L1	L2	TDL (KG)
SS-360LK-06	5.2	13.2	11.3	22.2	36	550
SS-360LK-08	8.2	15.8	15.7	28	48	1120
SS-360LK-10	9.92	19.84	19.2	35	58.2	1600

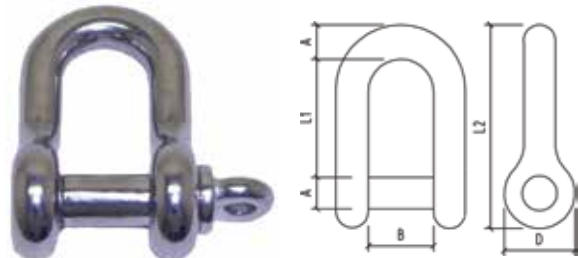

DEE SHACKLE WITH OVERSIZE PIN

Code	PIN	BODY	B	D	L1	L2	TDL (KG)
SS-3611-103	10.6	9.8	31.9	16.1	23.5	57.5	2200
SS-3611-1035	12.5	11.4	38	20.7	28	70	2400
SS-3611-104	15.4	12.7	42.5	20.7	31.7	78	3600
SS-3611-105	18.6	15.8	49.7	27.1	39.2	95.5	4400

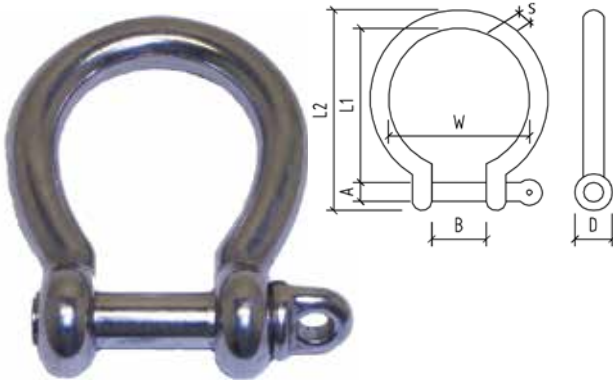

BOW SHACKLE

Code	S	B	D	W	L1	L2	TDL (KG)
SS-370F-03	2.9	6.3	7	9.1	13	19.3	140
SS-370F-05	5	11	10	18	27	40	300
SS-370F-06	5.8	13.6	11.9	20.6	31	46	520
SS-370F-08	7.8	17.9	16	25.5	36.7	57	1050
SS-370F-10	9.7	20.8	20	34.1	46.75	70.7	1300
SS-370F-12	11.8	25.8	23.9	41.9	58.3	86.5	2200
SS-370-16	15.6	31.8	31.9	56	74.8	115.5	3375
SS-370-22	21.6	43.7	44	75	98	150	5200

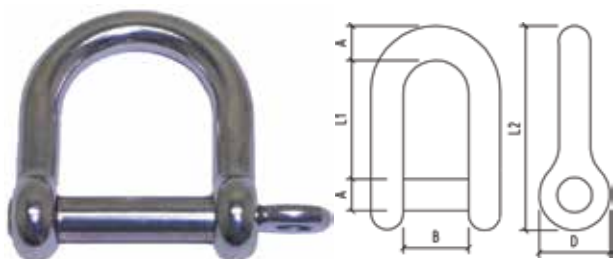

WIDE DEE SHACKLE

Code	A	B	D	L1	L2
SS-360W-08	8	28.3	15.5	31	50
SS-360W-12	11.5	49.2	23.3	64.4	92

F = FORGED
TDL = TESTED DEFORMATION LOAD

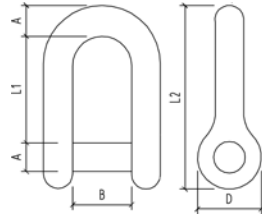

SEMI ROUND DEE SHACKLE

Code	A	B	D	L1	L2
SS-3611-05	3.95	11.9	12	19.5	31.6
SS-3611-06	4.8	12.9	13.7	22	36.9
SS-3611-08	6.4	18	18	27.2	46.6

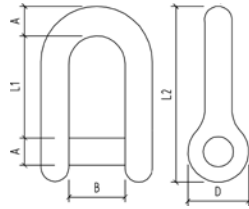

TWISTED SHACKLE

Code	A	B	D	L1	L2	TDL(KG)
SS-380-06	5.1	13.4	11	33	46.5	TBA
SS-380-08	7.7	17.4	15.4	40	59.5	1120
SS-380-10	10	20	19.7	46.8	70	1600

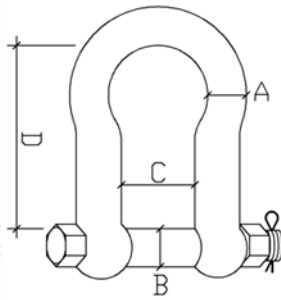

ANCHOR SHACKLE

Code	A	B	C	D	TDL (KG)
SS-2711BB-516	5/16"	94.00	13.9	32.5	1500
SS-2711BB-38	3/8"	10.97	16.3	36.4	2200
SS-2711BB-716	7/16"	12.72	20.64	43.87	3500
SS-2711BB-58	5/8"	19.05	27.00	68.30	TBA
SS-2711BB-34	3/4"	21.96	29.87	73.7	8000

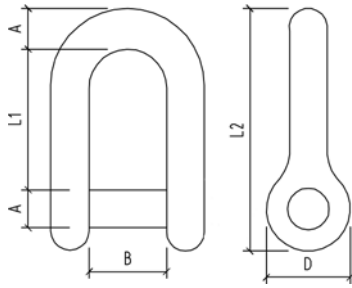

SLOTTED HEAD DEE SHACKLE

Code	A	B	D	L1	L2	TDL (KG)
SS-360C-04	4	8	7.9	14	24	280
SS-360C-06	6	12	12	21	35	550
SS-360C-07	7	14	14	25	42	720
SS-360C-08	8	17	15.9	28.6	48	1120
SS-360C-10	10	20	20	35	59	1600

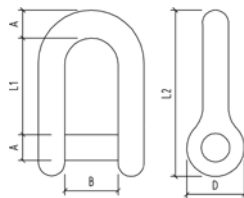

SEMI ROUND D SLOT HEAD SHACKLE - 304 GRADE

Code	A	B	D	L1	L2	TDL (KG)
SS-361-05	5	12	12.5	19.4	30	400
SS-361-06	6	13	14	22	36	550
SS-361-08	8	17.6	18	27	47	1120

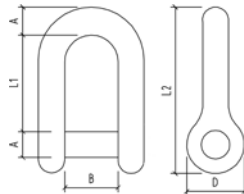

SQUARE HEAD DEE SHACKLE

Code	A	B	D	L1	L2	TDL (KG)
SS-360B-10	10	21.3	20	35	59	1600
SS-360B-12	12	24.3	23.4	42.4	71	2400

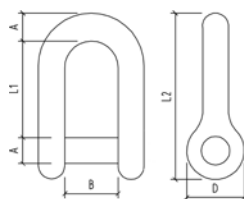

LONG DEE SHACKLE

Code	A	B	D	L1	L2	TDL (KG)
SS-362-04	4.4	9	7.6	32	40.8	200
SS-362LK-06	5.25	12.7	11.6	45.5	59.2	550
SS-362LK-08	7.1	15.5	15.5	60	80	1120
SS-362-10	10	21.5	20	75.5	99	1600
SS-362-12	12	27	53.3	90	118	2400

TDL = TESTED DEFORMATION LOAD

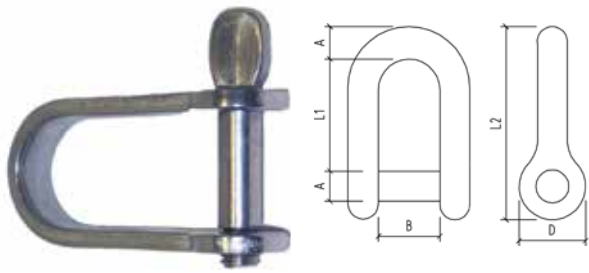

LIGHT WEIGHT STRIP SHACKLE - 304 GRADE

Code	A	B	D	L1	L2
SS-162-04	4	10	10	17	25

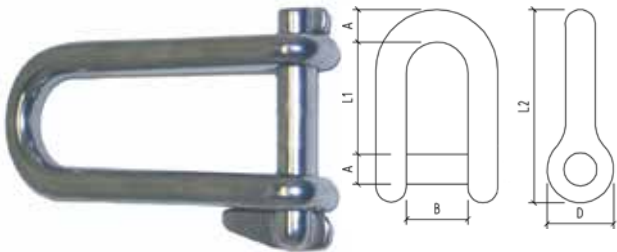

HEAD BOARD SHACKLE CAPTIVE PIN

Code	A	B	D	L1	L2	TDL (KG)
SS-3651-05	4.9	13	11	39	50	400
SS-3651-06	5.8	15.9	12.5	43.9	57.3	550
SS-3651-08	7.8	19.9	16.4	60	78.8	1120



SWIVEL EYE SNAP SHACKLE

Code	L	A	B	TDL (KG)
SS-2482-01	67.9	16	13	400
SS-2482-02	89	24	17	1200
SS-2482-03	126	31	23	1800



FIXED EYE SNAP SHACKLE

Code	L	A	B	TDL (KG)
SS-2481-01	55	15	13	400
SS-2481-02	70	22	13	1200
SS-2481-03	101	27	17	1800



SWIVEL JAW SNAP SHACKLE

Code	A	C	L	TDL (KG)
SS-2476-01	12	13	68	110
SS-2476-02	16	15	84	2000



CLEW SNAP SHACKLE

Code	A	C	L	TDL (KG)
SS-2464-01	12	15	52	1600
SS-2464-02	15	18	65	1200

LARGER SIZE SHACKLES AVAILABLE IN SOME STYLES. PRICE AND AVAILABILITY ON REQUEST.



SWIVEL EYE AND EYE

Code	D	L	B	L1	TDL (KG)
SS-018-06	6	65	15	13	550
SS-018-08	8	95	20.7	20	1120
SS-018-10	10	115	24	26	1600
SS-018-13	13	150	31	32	2700

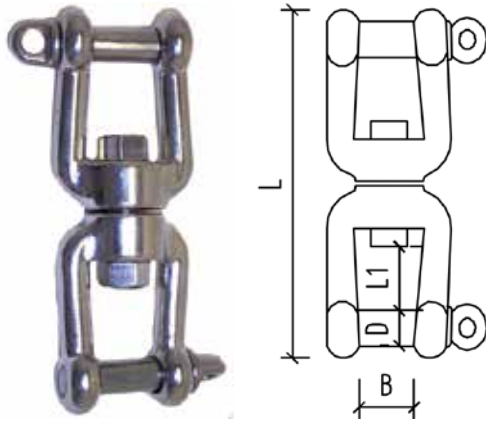

SWIVEL JAW AND JAW

Code	D	L	B	L1	TDL (KG)
SS-0182-06	6	66	11	11.5	550
SS-0182-08	8	94	16	16	1120
SS-0182-10	10	118	22	22	1600
SS-0182-13	13	154	27	22	2700
SS-0182-16	16	189	32	36	8500
SS-0182-19	19	221	38	41	10000

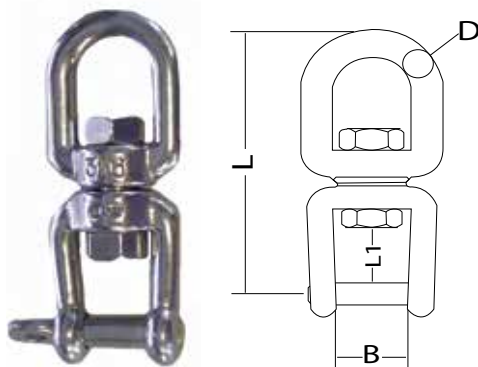

SWIVEL JAW AND EYE

Code	D	L	B	L1	TDL (KG)
SS-0181-06	6	60	12	11	550
SS-0181-08	8	80	16	15	1120
SS-0181-10	10	110	20	21	1600

STAINLESS STEEL CLEANING AND MAINTENANCE SCHEDULE

ENVIRONMENT	DISTANCE FROM SALT SPRAY, BEACHFRONT	CLEANING INTERVAL
MILD	15KM+	EVERY 12 MONTHS
MODERATE	1 – 15KM	EVERY 4 – 6 MONTHS
MARINE/INDUSTRIAL / URBAN	500M – SALT SPRAY / BEACHFRONT 100M – 1KM – SHELTERED BAY	EVERY 3 MONTHS
SEVERE MARINE / INDUSTRIAL / BUSY URBAN	500M – SALT SPRAY / BEACHFRONT 100M – SHELTERED BAY	WEEKLY

STAINLESS STEEL CLEANER AND POLISH

