

ROUND RING - 304 GRADE

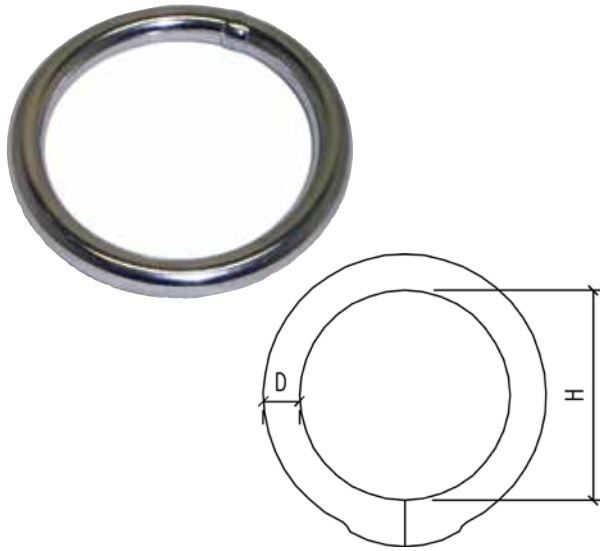

CODE	D	H
SS-1717-04	4	25
SS-1717-05	5	35
SS-1717-54	5	40
SS-1717-565	5	65
SS-1717-06	6	40
SS-1717-650	6	50
SS-1717-08	8	55
SS-1717-875	8	75
SS-1717-1075	10	75
SS-1717-10100	10	100
SS-1717-12120	12	120



STAINLESS STEEL TRIANGLE - 304 GRADE

CODE	D	L
SS-325T-650	6	50
SS-325T-850	8	50

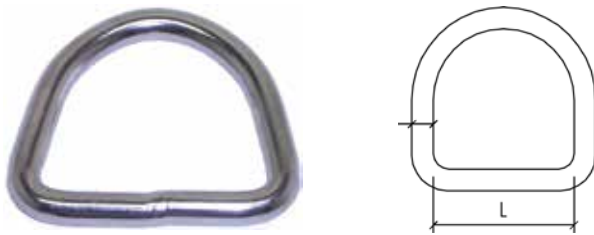

STAINLESS STEEL DEE RING - 304 GRADE

CODE	D	L
SS-325-320	3	20
SS-325-425	4	25
SS-325-638	6	38
SS-325-64	6	40
SS-325-65	6	50
SS-325-85	8	50

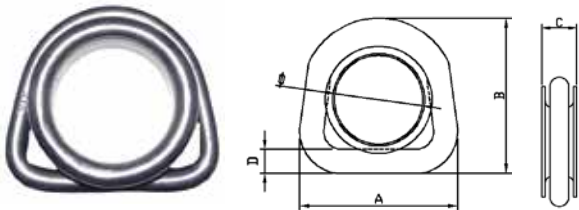

STAINLESS STEEL DEE WITH THIMBLE

CODE	Ø	A	B	C	D
SS-3254-06	24	42	43	11	6
SS-3254-08	35	66.5	59	19	8
SS-3254-10	41	82	74	20	10

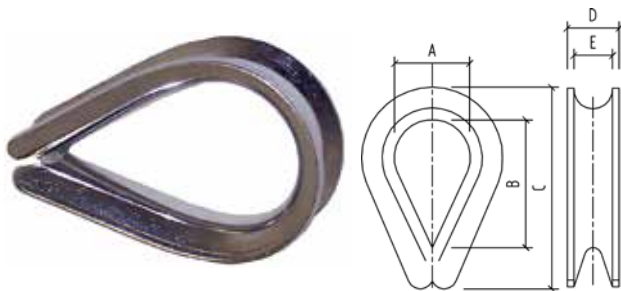

LIGHT WEIGHT WIRE ROPE THIMBLE - 304 GRADE

CODE	ROPE SIZE	C	D	A	E	B
SS-234-02	2MM	23	5	8	3	16
SS-234-03	3MM	25	5.5	10	4.5	18
SS-234-04	4MM	27	6.5	11	5	19
SS-234-05	5MM	32.5	7	14	6	22
SS-234-06	6MM	36	9.5	17	7	27
*SS-234-08	8MM	50	12	20	9	35
SS-234-10	10MM	60	15	25	11	40
SS-234-12	12MM	68	18	30	14	47
SS-234-14	14MM	71	19	34.5	16	51
SS-234-16	16MM	82	22	36	18	61
SS-234-18	18MM	92	25	41	20	65
SS-234-20	20MM	100	26.5	43	22	75
SS-234-22	22MM	107	30.5	46	26	79
SS-234-25	25MM	111	35	48.5	30	78

* AVAILABLE IN G316 - SS-234-08/316

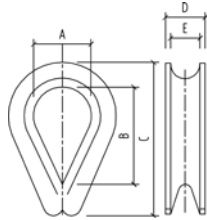

HEAVY DUTY WIRE ROPE THIMBLE

CODE	ROPE SIZE	C	D	A	E	B
SS-414-1/4	1/4"	56	10	23.5	7	43
SS-414-5/16	5/16"	63	12.5	28	9	49
SS-414-3/8	3/8"	73	15	29	10.5	55
SS-414-1/2	1/2"	92	20	38	13	65
SS-414-5/8	5/8"	106	23.5	45	17	83
SS-414-3/4	3/4"	125	31	51	23	95
SS-414-1	1"	157.5	37.5	65.5	25.4	118

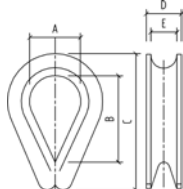

HEAVY DUTY CLOSED WIRE ROPE THIMBLE

CODE	ROPE SIZE	C	D	A	E	B
SS-2344-10	10MM	67	13.5	28.5	10	51
SS-2344-12	12MM	86	16.3	36.5	11	62
SS-2344-16	16MM	109.5	22.5	47	14	82

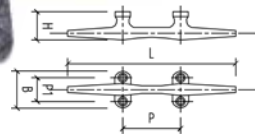

STAINLESS STEEL MOORING CLEAT

CODE	L	B	P	P1	H
SS-508-06	6" 150MM	45	56	27	31.5
SS-508-08	8" 200MM	54	75	34	38
SS-508-10	10" 250MM	69	93	46.7	48.5

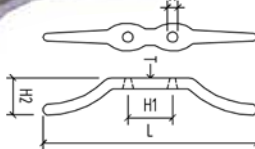

STAINLESS STEEL ROPE CLEAT

CODE	L	H1	H	T	H2
SS-4015-01	68	21	4	4	12
SS-4015-02	113	35	5.8	6	20
SS-4015-03	150	37	6.8	8	29

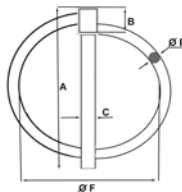

LINCH PIN

CODE	A	B	C	E	F
SS-3193-04	47	7.4	4.4	2.6	37.8
SS-3193-06	55	7.8	6	3.2	44
SS-3193-08	56	8.3	7.4	3.2	44

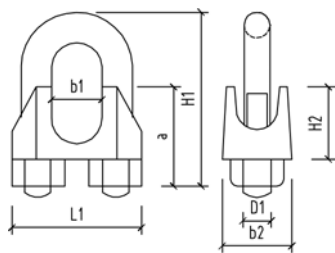

WIRE ROPE GRIP

CODE	ROPE SIZE	B	B1	B2	D1	H1	H2	L1
SS-260-02	2MM	12	4	14	3	18	10	13
SS-260-03	3MM	14	5.5	16	3	22	11	16
SS-260-03/HD	3MM	12	4	14	4	18	10	13
SS-260-04	4MM	16	6	18	4	23	13	18
SS-260-05	5MM	19	7	21	5	27	15	21
SS-260-06	6MM	22	9	22	5	32	17	27
SS-260-08	8MM	27	11	28	8	40	20	34
SS-260-10	10MM	32	12	35	10	50	24	45
SS-260-12	12MM	37	15	38	12	62	28	50
SS-260-14	14MM	40	18	44	13	65	32	52
SS-260-16	16MM	47	20	47	13	78	34	59
SS-260-19	19MM	51	22	53	13	82	39	62
SS-260-25	25MM	65	28	62	16	105	53	76

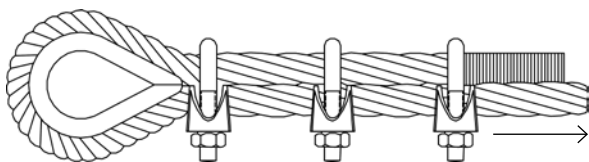

Attach Wire Rope Grips as shown in the above diagram.
Note: Pulling wire sits on the base of the grip.



DUPLEX WIRE GRIP - 304 GRADE

CODE	ROPE SIZE	L	B
SS-512-03	3MM	40	18